

71" TANYA ACRYLIC FREESTANDING TUB

Cat. No.
ATDRSN71RIG-XX



Features:

- ▶ Acrylic construction for lighter weight
- ▶ Sleek contemporary design
- ▶ Drain and overflow covers included (available in 6 finishes)
- ▶ Rim measurement: 1-3/8"
- ▶ Overflow slot with integrated drain
- ▶ Drain included
- ▶ No faucet holes
- ▶ Includes build in adjusters
- ▶ Angle slope of tub: 29°
- ▶ IAMPO certified
- ▶ Tub is thoroughly inspected before shipment
- ▶ Option to add insulation between tub walls available

Finishes:

- WT** White
- CP** Polished Chrome
- BN** Brushed Nickel
- PN** Polished Nickel
- ORB** Oil Rubbed Bronze
- PB** Polished Brass

Custom Colors Available (inside of tub is always white enamel):
Painted bathtubs are considered "special order" and are not returnable
\$160 Bisque or Black \$250 Designer Color

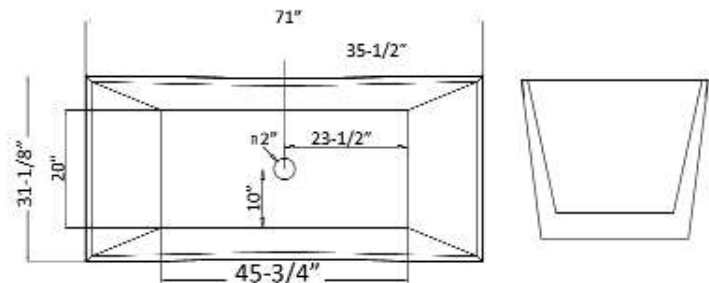
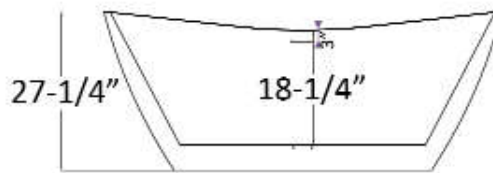

L: 71"
W: 31-1/8"
H: 24" lowest, 27-1/4" highest

Water depth: 18-1/4" to top of tub
Water depth: 15-1/8" to overflow
Overflow hole diameter: 3" x 1/2"
Center of drain to back of rim: 15-1/2"
Bottom of drain to floor: 4-1/4"
Bathing well to floor: 6"

The following is recommended for
ATDRSN71RIG-WH:

- Faucets: part # 7082, or #7088
- Rigid, freestanding supplies: part #4502
- Freestanding filler: part #7902 or #7934
(Supplies included with filler)



For easier installation we
recommend use of 5598-ITD
Easy Install Rough In Kit

Gallon Capacity: 67
Shipping Weight: 142 lbs.
Empty Weight: 82 lbs.
Filled Weight: 642 lbs.

Dimensions of fixture are nominal and specifications subject to change without notice.